

Guide – Chrome Remote Support

Downloading the tool:

- Connect to the internet using the Chrome browser and go to the website remotedesktop.google.com/support
- Click “Remote Support.”
- In the section labeled “Get Support,” click the arrow to download.
- When the web page opens, click “Add to Chrome.” A box will pop up to explain what this tool does. Click “Add Extension.”

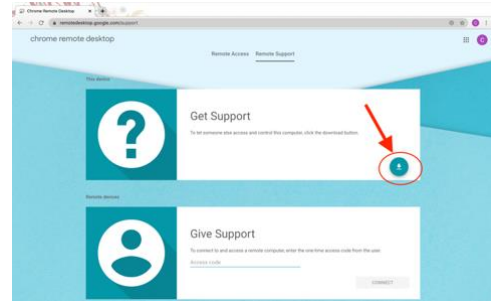

Sharing an access code:

- Go to the website remotedesktop.google.com/support
- In the “Get Support” section, there will now be a button that says “Generate Code.” When you and your TechOWL support person are both ready, click this button to get your code.
- Tell your TechOWL support person this code. Read all twelve numbers.
- After the staff member enters the code, a box will pop up for you to give them permission to see your computer.

