

Guide – Get Started with your Chromebook

Getting Started

Find the following parts on your computer:

- Charger port on the upper left side of the Chromebook
- On/off button on the upper right corner of the face of the Chromebook (when opened)
- Track pad which is on the bottom of the Chromebook face (when opened)

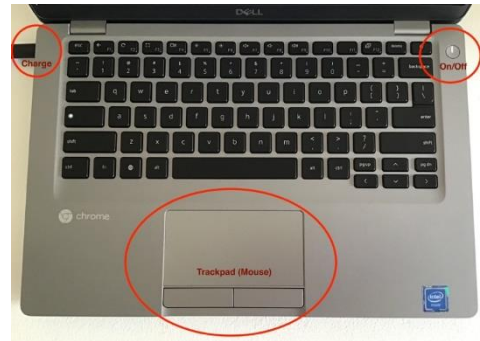

Starting up the computer

- The first time you turn the computer on, you will see a welcome screen. Click the blue “Let’s go” button.
- Connect to the internet. Choose your network name, enter the password, and press connect.
- Accept terms of service from Google.
- Skip the “Enroll your device” step. You do not need the Chrome Enterprise Upgrade, so click “Don’t enroll” when it is offered

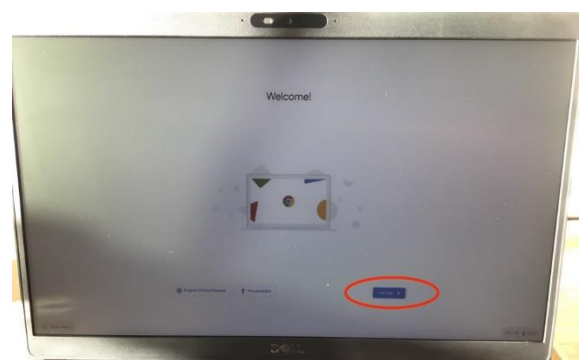

Sign in

- If you have a Google account, you can use that email address to sign in.
- If you do not have a Google account, click “more options” to make a new account. You will enter information like your name and birthday, choose an email address and password, and agree to the terms of service

